

cecotec

CECOMIXER EASY WHITE

Batidora amasadora/Stand mixer



Manual de instrucciones
Instruction manual
Manuel d'instructions
Bedienungsanleitung
Manuale di istruzioni
Manual de instruções
Instructiehandleiding
Instrukcja obsługi
Návod k použití

ÍNDICE

1. Instrucciones de seguridad	4
2. Piezas y componentes	5
3. Funcionamiento	5
4. Limpieza y mantenimiento	6
5. Especificaciones técnicas	6
6. Reciclaje de electrodomésticos	6
7. Garantía y SAT	7

INDEX

1. Safety instructions	8
2. Parts and components	8
3. Operation	9
4. Cleaning and maintenance	10
5. Technical specifications	10
6. Disposal of old electrical appliances	10
7. Technical support service and warranty	10

SOMMAIRE

1. Instructions de sécurité	12
2. Pièces et composants	13
3. Fonctionnement	13
4. Nettoyage et entretien	14
5. Spécifications techniques	14
6. Recyclage des électroménagers	14
7. Garantie et SAV	15

INHALT

1. Sicherheitshinweise	16
2. Teile und Komponenten	17
3. Bedienung	17
4. Reinigung und Wartung	18
5. Technische Spezifikationen	18
6. Entsorgung von alten Elektrogeräten	18
7. Garantie und Kundendienst	19

INDICE

1. Istruzioni di sicurezza	20
2. Parti e componenti	20
3. Funzionamento	21
4. Pulizia e manutenzione	22
5. Specifiche tecniche	22
6. Riciclaggio di elettrodomestici	22
7. Garanzia e SAT	23

ÍNDICE

1. Instruções de segurança	24
2. Peças e componentes	24
3. Funcionamento	25
4. Limpeza e manutenção	26
5. Especificações técnicas	26
6. Reciclagem de eletrodomésticos	26
7. Garantia e SAT	27

INHOUD

1. Veiligheidsinstructies	28
2. Onderdelen en componenten	28
3. Werking	29
4. Schoonmaken en onderhoud	30
5. Technische specificaties	30
6. Recyclage van elektrische apparaten	30
7. Garantie en technische ondersteuning	31

SPIS TREŚCI

1. Zasady bezpieczeństwa	32
2. Części i komponenty	32
3. Obsługa urządzenia	33
4. Czyszczenie i konserwacja	34
5. Dane techniczne	34
6. Recykling sprzętu	34
7. Gwarancja i Pomoc Techniczna	35

OBSAH

1. Bezpečnostní pokyny	36
2. Části a složení	36
3. Fungování	37
4. Čištění a údržba	38
5. Technické specifikace	38
6. Recyklace elektrospotřebičů	38
7. Záruka a technický servis	38

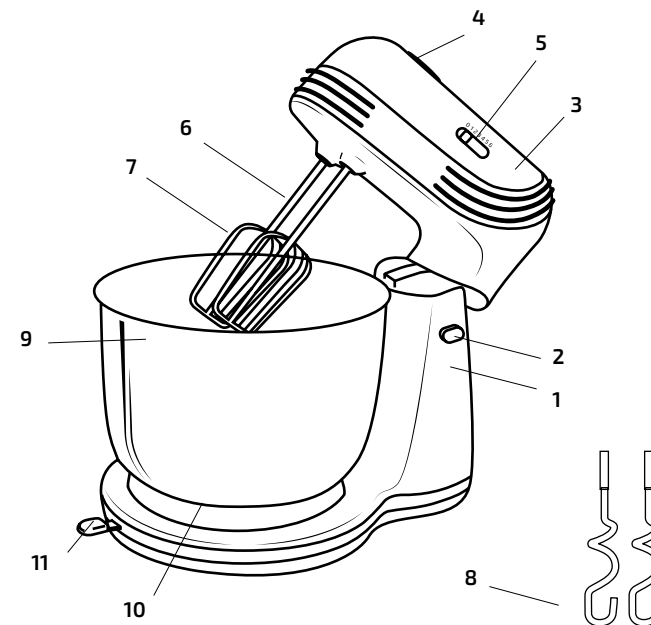

Fig./Img./Abb./Afb./ Rys./Obr. 1



Fig./Img./Abb./Afb./ Rys./Obr. 2

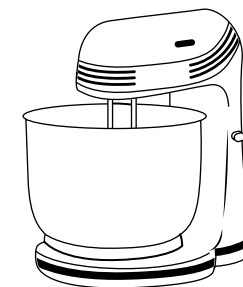

Fig./Img./Abb./Afb./ Rys./Obr. 3

1. SAFETY INSTRUCTIONS

Read these instructions thoroughly before using the appliance. Keep this instruction manual for future reference or new users. This appliance can be used by people with reduced physical, sensory or mental capabilities, or lacking experience and knowledge, provided that they are supervised or instructed on the possible risks of the use of the appliance.

This device must not be used by children. Keep the appliance and its cable out of the children's reach.

Keep plastic bags or packing elements out of the kid's reach. They are potentially dangerous.

Do not connect the appliance without checking that the voltage on the plate and that of your household are the same.

WARNING: Do not immerse the main body of the appliance in water or any other liquid.

This appliance has been designed for domestic use only. It can knead up to 0.5 kg. Do not use the appliance for longer than 15 minutes. After this period of time, allow the appliance to cool down for a few minutes before using it again.

Do not leave the appliance unattended while in use.

Do not use the device unladen.

Children shall not play with the appliance. Keep the device out of their reach.

Make sure neither the device nor its cable are in direct contact with hot surfaces or objects.

Always disconnect it from the mains when assembling/disassembling any of the accessories.

Do not leave the device plugged in if it is not going to be used.

If the power cord is impaired, it must be replaced by the official Technical Support Service of Cecotec.

2. PARTS AND COMPONENTS

Fig. 1

1. Body
2. Tilt support button
3. Tilt support
4. Rods releasing button

5. Speed selector
6. Rod holes
7. Mixing rods
8. Kneading rods
9. Bowl
10. Swivel base
11. Bowl-slide knob

Fig. 2

Fig. 3

3. OPERATION

Keep pushing the tilt support button (2) and lift up the tilt support (3) (Fig. A).

For placing the bowl (9) on the swivel base (10), keep pressing the swivel base and turn the bowl to the desired direction.

Place the rods you want to use into the support holes.

WARNING: The rods that have a ring in the axis must be placed in the hole with a bigger diameter of the blender, specified by letter "R". If not, there is risk of spilling the dough.

MIXING RODS (7): For liquid mixtures, creams, egg whites, etc.

KNEADING RODS (8): For pastries and light doughs.

Place the rods in the corresponding holes, pressing and turning them until they fit perfectly.

Always use the rods jointly. Never place a rod of each kind.

Keep pushing the tilt support button (2) and lift up the tilt support (3) (Fig. 2).

Choose the speed with the speed selector (5).

We suggest starting the appliance at the lowest speed (position 1) and then gradually increase the speed until reaching the higher speed (position 6). However, depending on the consistency of the food, you may set the highest speed from the beginning.

Use the bowl slide knob (11) to move or keep the bowl still. Press and slide to the left to activate the bowl slide. This will result on a more homogeneous mixture (Fig. 3).

Once done using the device, set the speed selector (5) to "0" position and unplug it from the mains.

Keep pushing the tilt support button (2) and lift it up.

Press the rod release button (4) to release the rods.

Keep the swivel base still and turn the bowl in the desired direction for removing the bowl.

4. CLEANING AND MAINTENANCE

Before cleaning the device, make sure that the appliance is disconnected from the mains. The accessories can be cleaned with soap and water. Try to clean the appliance as soon as you finish using it, as the dry texture of some food may be difficult to remove. Clean the body of the blender with a cloth dampened in water. Do not use abrasive or chemical products, such as metallic scourers, which may deteriorate the surfaces of the appliance.

5. TECHNICAL SPECIFICATIONS

Model: Cecomixer Easy White
Product reference: 04128
250 W, 220-240 V ~, 50/60 Hz
Made in China | Designed in Spain

6. DISPOSAL OF OLD ELECTRICAL APPLIANCES

The European directive 2012/19/EU on Waste Electrical and Electronic Equipment (WEEE), specifies that old household electrical appliances must not be disposed of with the normal unsorted municipal waste. Old appliances must be collected separately, in order to optimize the recovery and recycling of the materials they contain, and reduce the impact on human health and the environment. The crossed out "wheeled bin" symbol on the product reminds you of your obligation to dispose of the appliance correctly. If the product has a built-in battery or uses batteries, they should be removed from the appliance and disposed of appropriately. Consumers must contact their local authorities or retailer for information concerning the correct disposal of old appliances and/or their batteries.



The product has been disassembled, modified, or repaired by persons, not authorised by the official Technical Support Service of Cecotec.
Faults deriving from the normal wear and tear of its parts, due to use.

The warranty service covers every manufacturing defects of your appliance for 2 years, based on current legislation, except consumable parts. In the event of misuse, the warranty will not apply. If at any moment you detect any problem with your product or have any doubt, do not hesitate to contact Cecotec Technical Support Service at +34 963 210 728.

7. TECHNICAL SUPPORT SERVICE AND WARRANTY

This product is under warranty for 2 years from the date of purchase, as long as the proof of purchase is submitted, the product is in perfect physical condition, and it has been given proper use, as explained in this instruction manual. The warranty will not cover the following situations:
The product has been used for purposes other than those intended for it, misused, beaten, exposed to moisture, immersed in liquid or corrosive substances, as well as any other fault attributable to the customer.

www.cecotec.es

Grupo Cecotec Innovaciones S.L.
C/ de la Pinadeta s/n, 46930
Quart de Poblet, Valencia (Spain)
YV01191209